

| | | |
|--------------------------------|---|---|
| Applicable to | : | RGSS58 |
| Manufacturer | : | www.frontlinefall.com |
| Certification Body | : | SATRA Technology Centre Kettering, Northants, UK (Notified Body 0321) |
| Ongoing Assessment Body | : | SGS United Kingdom Ltd., Unit 202B, Worle Parkway, Weston-super-Mare, BS22 6WA, UNITED KINGDOM. (Notified Body 0120) |

Do not skip this instruction manual. Read the instruction manual carefully before using the equipment. If failed in doing so it may cause serious Injury or Death.

INTRODUCTION:-

Thank you for purchasing a Frontline RGSS58 This manual must be read and understood in its entirety, and used as part of an employee training program as required by OSHA or any applicable state agency.

This and any other included instructions must be made available to the user of the equipment. The user must understand how to safely and effectively use the RGSS58, and all fall safety equipment used in combination with the RGSS58.

Applicable Safety Standards

When used according to instruction specifications, this product meets or exceeds **ANSI Z359.1-2007** standards for fall protection. Applicable standards and regulations depend on the type of work being done, and also might include state-specific regulations. Consult regulatory agencies for more information on personal fall arrest systems and associated components.

Worker Classifications

Qualified Person: A person with an accredited degree or certification, and with extensive experience or sufficient professional standing, who is considered proficient in planning and reviewing the conformity of fall protection and rescue systems

Competent Person: A highly trained and experienced person who is ASSIGNED BY THE EMPLOYER to be responsible for all elements of a fall safety program, including, but not limited to, its regulation, management, and application. A person who is proficient in identifying existing and predictable fall hazards, and who has the authority to stop work in order to eliminate hazards.

Authorized Person: A person who is assigned by their employer to work around or be subject to potential or existing fall hazards

It is the responsibility of a Qualified or Competent person to supervise the job site and ensure all applicable safety regulations are complied with.

IMPORTANT BEFORE INSTALLATION AND USE :-

Prior to use, plan your system:

1. Ensure all PFAS equipment is selected and deemed compatible by a Competent Person.
2. Eliminate or minimize all risk of swing fall.
3. Determine desired location for Lifeline; ensure location is free of

debris, rot, decay, cracking, and hazardous materials.

4. Installation, set-up, and use of Lifeline system must be done under the supervision of a Qualified Person.

Installation and Use

1. Eliminate all risk of lower end and termination. Either ensure Vertical Lifeline Assembly(VLA) will prevent user from striking next lower level and that there is always adequate fall clearance, or that VLA will not reach the leading edge of any fall hazard when used at its full length. NEVER tie knot in lifeline, except at extreme bottom of lifeline in order to prevent Fall Arrest from detaching.
2. Eliminate or minimize all risk of swing fall.
3. Attach snap hook with integrated Shock Pack to compatible anchorage connector.
4. Attach snap hook with integrated Fall Arrest to applicable harness D-ring.
5. To move along lifeline, compress and hold Fall Arrest handle. ALWAYS adjust Fall Arrest to reduce slack in the system as much as possible. When attached to a Fall Arrest and moving along work surface, ALWAYS do so by moving Fall Arrester along rope, and NEVER by moving only the rope itself. For example, if moving from a roof edge to the roof peak, engage handle of fall Arrester and move it up the Vertical Lifeline Assembly (VLA) while walking to peak. DO NOT move up to roof peak by moving VLA and keep Fall Arrest stationary; doing so can create free fall in excess of levels permitted by system.
6. To restrict Fall Arrest movement along lifeline, release Fall Arrest handle.
7. Fall Arrester RGSS58 comes with an anti-panic feature which automatically acts in case the user holds the fall arrester and grasps it too tightly. However, care must be taken that never grab fall arrester in the event of fall.
8. NEVER work above the Fall Arrester unless free fall is limited to 6' or less.

WARNING: One connection per Vertical Lifeline Assembly(VLA). NEVER attempt to remove components from VLA.

Do not alter & misuse the equipment.

Follow these steps to install the Fall Arrester

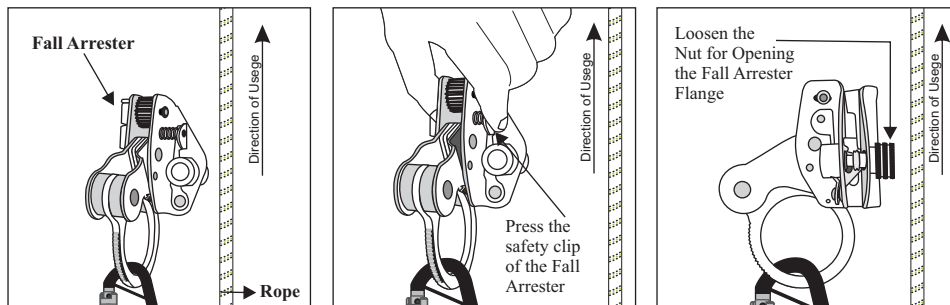

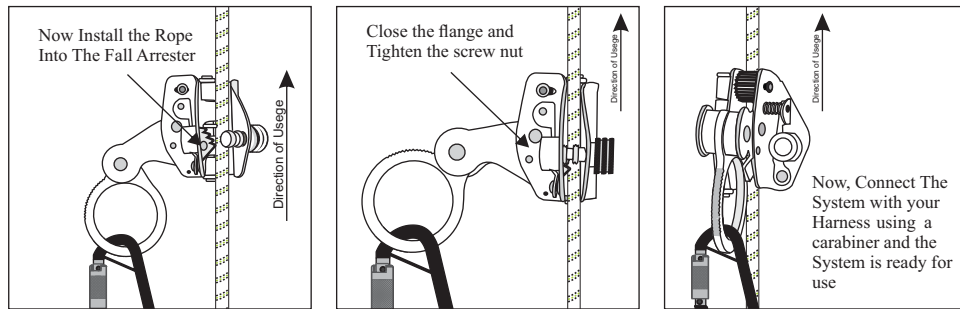

NOTE:-

- Workplace conditions, including, but not limited to, flame, corrosive chemicals, electrical shock, sharp objects, machinery, abrasive substances, weather conditions, and uneven surfaces, must be assessed by a Competent Person before fall protection equipment is selected.
- The analysis of the workplace must anticipate where workers will be performing their duties, the routes they will take to reach their work, and the potential and existing fall hazards they may be exposed to. Fall protection equipment must be chosen by a Competent Person. Selections must account for all potential hazardous workplace conditions. All fall protection equipment should be purchased new and in an unused condition.
- Fall protection systems must be selected and installed under the supervision of a Competent Person, and used in a compliant manner.
- Fall protection systems must be designed in a manner compliant with all federal, state, and safety regulations.
- Forces applied to anchors must be calculated by a Competent Person.
- Harnesses and connectors selected must be compliant with manufacturer's instructions, and must be of compatible size and configuration.
- A pre-planned rescue procedure in the case of a fall is required. The rescue plan must be project specific. The rescue plan must allow for employees to rescue themselves, or provide an alternative means for their prompt rescue.
- Store rescue equipment in an easily accessible and clearly marked area.
- Training of Authorized Persons to correctly erect, disassemble, inspect, maintain, store, and use equipment must be provided by a Competent Person.
- Training must include the ability to recognize fall hazards, minimize the likelihood of fall hazards, and the correct use of personal fall arrest systems.
- NEVER use fall protection equipment of any kind to hang, lift, support, or hoist tools or equipment, unless explicitly certified for such use.
- Maintenance of equipment must be done according to manufacturer's instructions. Equipment instructions must be retained for reference.
- Prior to EACH use, all equipment in a fall protection system must be inspected for any potential or existing deficiencies that may result in its failure or reduced functionality. IMMEDIATELY remove equipment from service if any deficiencies are found.
- Equipment must be inspected by a Competent Person at least every six months. These inspections must be documented in equipment instruction manual and on equipment inspection grid label.
- Equipment must be inspected for defects, including, but not limited to, the absence of required labels or markings, improper form/fit/function, evidence of cracks, sharp edges, deformation, corrosion, excessive heating, alteration, excessive wear, fraying, knotting, abrasion, and absence of parts.

- Equipment that fails inspection in any way must immediately be removed from use, or repaired by an entity approved by the manufacturer.
- No on-site repair of equipment unless explicitly permitted by the manufacturer.
- Equipment subjected to forces of fall arrest must immediately be removed from use. Snap hooks, carabiners, and other connectors must be selected and applied in a compatible fashion. All risk of disengagement must be eliminated. All snap hooks and carabiners must be self-locking and self-closing, and must never be connected to each other.
- Age, fitness, and health conditions can seriously affect the worker should a fall occur. Consult a doctor if there is any reason to doubt a user's ability to withstand and safely absorb fall arrest forces or perform set-up of equipment.
- Pregnant women and minors must not use this equipment. Physical harm may still occur even if fall safety equipment functions correctly. Sustained post-fall suspension may result in serious injury or death. Use trauma relief straps to reduce the effects of suspension trauma. Allowable individual worker weight limit (including all equipment), unless explicitly stated otherwise, is 40-100 kgs..

MAINTENANCE, CLEANING, AND STORAGE

- Repairs to RGSS58 can only be made by an entity authorized by the manufacturer. A RGSS58 fails inspection in any way, immediately remove it from service, and contact manufacturer to inquire about its return or repair.
- Cleaning after use is important for maintaining the safety and longevity of RGSS58.
- Remove all dirt, corrosives, and contaminants from RGSS58 before and after each use. If RGSS58 cannot be cleaned with plain water, use mild soap and water, then rinse and wipe dry. NEVER clean RGSS58 with corrosive substances.
- When not in use, store equipment where it will not be affected by heat, light, excessive moisture, chemicals, or other degrading elements.

LIMITATIONS

Fall Clearance: There must be sufficient clearance below the anchorage connector to arrest a fall before the user strikes the ground or an obstruction. When calculating fall clearance, account for a MINIMUM 3' safety factor, deceleration distance, user height, length of lanyard/SRL, and all other applicable factors.

Swing Falls: Prior to installation or use, make considerations for eliminating or minimizing all swing fall hazards. Swing fall occurs when the anchor is not directly above the location where a fall occurs. Always work close or in line with anchor point as possible. Swing falls significantly increase the likelihood of serious injury or death in the event of a fall.

Compatibility: When making connections with RGSS58, eliminate all possibility of roll-out. Roll out occurs when interference between a hook and the attachment point causes the hook gate to unintentionally open and release. All connector gates must be self closing and self-locking and withstand minimum load of 3600 lbs.

Vertical Lifeline Assembly (VLA): Specific Applications

WARNING: Use of equipment in unintended applications may result in serious injury or death. Maximum 1 attachment per connection point.

Personal Fall Arrest: RGSS58 may be used in Personal Fall Arrest applications to support a MAXIMUM 1 Personal Fall Arrest System (PFAS). Structure must withstand loads applied in the directions permitted by the system of at least 5,000 lbs.

Restraint: VLA may be used in Restraint applications. Restraint systems prevent workers from reaching the leading edge of a fall hazard. Always account for fully deployed length of lanyard/ VLA. Structure must withstand loads applied in the directions permitted. Restraint system may only be used on surfaces with slopes up to 4/12 (vertical/horizontal). Applicable D-rings:

For all applications: worker weight capacity range (including all clothing, tools, and equipment) is 130-310 lbs.

VLA: Inspection

KEEP INSTRUCTIONS AVAILABLE FOR REFERENCE.

Record date of first use

Prior to each use, inspect the VLA for deficiencies, including, but not limited to, corrosion, deformation, pits, burrs, rough surfaces, sharp edges, cracking, rust, paint buildup, excessive heating, alteration, broken stitching, fraying, bird caging, and missing or illegible labels. IMMEDIATELY remove VLA from service if defects or damage are found, or if exposed to forces of fall arrest.

Ensure that applicable work area is free of all damages, including, but not limited to debris, rot, rust, decay, cracking, and hazardous materials. Ensure that selected work area will support the application-specific minimum loads set forth in this instruction manual. Work area must be stable.

At least every 6 months, a competent person other than the user must inspect VLAs. Competent Person inspection MUST be recorded in instruction manual and on equipment inspection grid label. The Competent Person must sign their initials in the box corresponding to the month and year the inspection took place.

During inspection, consider all application

INSPECTION

- KEEP INSTRUCTIONS AVAILABLE FOR REFERENCE. Record Date of First Use
- Prior to EACH use, inspect RGSS58 for deficiencies, including, but not limited to, corrosion, deformation, pits, burrs, rough surfaces, sharp edges, cracking, rust, paint buildup, excessive heating, alteration, broken stitching, fraying, bird-caging, and missing or illegible labels. IMMEDIATELY remove RGSS58 from service if defects or damage are found, or if exposed to forces of fall arrest.
- Ensure that applicable work area is free of all damage, including, but not limited to, debris, rot, rust, decay, cracking, and hazardous materials. Ensure that selected work area will support the application-specific minimum loads set forth in this instruction manual. Work area MUST be stable.
- At least every 6 months, a Competent Person other than the user must inspect RGSS58. **Competent Person inspections MUST be recorded in inspection log in instruction manual and on equipment inspection grid label. The Competent Person must sign their initials in the box corresponding to the month and year the inspection took place.**
- During inspection, consider all applications and hazards RGSS58 have been subjected to.

PRODUCT SPECIFIC APPLICATIONS

WARNING: Use of equipment in unintended applications may result in serious injury or death. Maximum 1 attachment per connection point

Personal Fall Arrest: RGSS58 may be used to support a MAXIMUM 1 Personal Fall Arrest Systems (PFAS) for use in Fall Arrest applications. Structure must withstand loads applied in the directions permitted by the system of at least 15kN.

Restraint: RGSS58 may be used in Restraint applications. Restraint systems prevent workers from reaching the leading edge of a fall hazard. Always account for fully deployed length of lanyard/SRL. Structure must withstand loads applied in the directions permitted by the system of at least 15kN. No free fall is permitted.

For all applications: worker weight capacity range (including all clothing, tools, and equipment) is 310 lbs.

NEVER for simultaneous use in Fall Arrest and Restraint

Swing Falls: Prior to installation or use, make considerations for eliminating or minimizing all swing fall hazards. Swing falls occur when the anchor is not directly above the location where a fall occurs. Always work as close to in line with the anchor point as possible. Swing falls significantly increase the likelihood of serious injury or death in the event of a fall.

Compatibility: When making connections with RGSS58, eliminate all possibility of roll-out. Roll-out occurs when interference between a hook and the attachment point causes the hook gate to unintentionally open and release. All connections must be selected and deemed compatible with RGSS58 by a Competent Person.

Markings

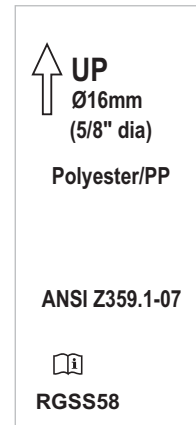

The Fall Arrester is marked with :

- (i) Identification of the manufacturer
- (ii) Type or product code & Ref. No
- (iii) Batch No / Year of Manufacture
- (iv) Read the manufacturer's instruction before use.
- (v) Minimum Breaking Strength

INSPECTION LOG

User must inspect prior to EACH use. Competent Person other than user must complete formal inspection at least every 6 months. Competent Person to inspect and fill the initial in the below inspections log.

Date of First Use: _____. Product lifetime is 10 years from Date of First Use, or, if not recorded, from Date of Manufacture, as long as it passes pre-use and Competent Person inspections.

DISCLAIMER- This information on the product is based upon technical data that Frontline obtained under laboratory conditions and believes to be reliable. Frontline does not guarantee results and take no liability or obligation in connection with this information. As conditions of end use are beyond our control it is the user's responsibility to determine the hazard levels and the use of proper personal protective equipment. Persons having technical expertise should undertake evaluation under their own specific end-use conditions, at their own discretion and risk. Please ensure that this information is only used to check that the product selected is suitable for the intended use. Any product that is damaged, torn worn or punctured should be discontinued from usage immediately.

| | | | | | | | | | | | | |
|----|----------|----------|----------|----------|----------|----------|----------|----------|----------|----------|----------|----------|
| | J | F | M | A | M | J | J | A | S | O | N | D |
| YR | | | | | | | | | | | | |
| YR | | | | | | | | | | | | |
| YR | | | | | | | | | | | | |
| YR | | | | | | | | | | | | |
| YR | | | | | | | | | | | | |

If equipment fails inspection **IMMEDIATELY REMOVE FROM SERVICE.**

| EQUIPMENT RECORD | | | | |
|---|---|---|--|------------------------------------|
| Product : | | | | |
| Model & type/identification | | Trade Name | | Identification number |
| Manufacturer | | Address | | Tel, fax, email into use |
| Year of manufacture | | Purchase Date | | Date first put into use |
| Other relevant information (e.g. document number) | | | | |
| PERIODIC EXAMINATION AND REPAIR HISTORY | | | | |
| Date | Reason for entry (periodic examination or repair) | Defects noted, repairs carried out and other relevant information | Name and signature of competent person | Periodic examination next due date |
| | | | | |
| | | | | |
| | | | | |